

EXISTING		PROPOSED	
LEGEND			
TRAVERSE LINE, CENTER LINE OR BASELINE (LABEL AS SUCH)			
RIGHT OF WAY LINE			
PROPERTY LINE			
EDGE OF PAVEMENT			
CURB FACE BACK			
DEPRESSED CURB			
SIDEWALK			
FENCES			
TREELINE			
ROADWAY SIGNS			
WETLAND LINE			
MUNICIPAL BOUNDARY LINE			
STALL COUNT			
ADA ACCESSIBLE STALL			
DEPRESSED CURB AND ADA RAMP			
DIRECTION OF TRAFFIC FLOW			

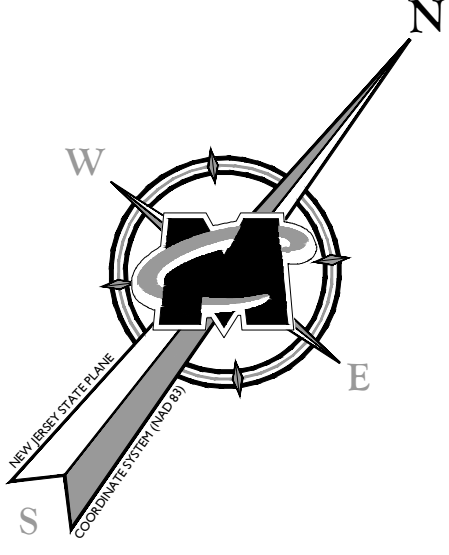

BLOCK 8, LOT 14
 N/F UNITED NJ RAILROAD & CANAL COMPANY
 (CAMDEN - AMBOY MAIN LINE)
 (CONRAIL (FORMERLY P.C.T. & CO.) CLASS I)

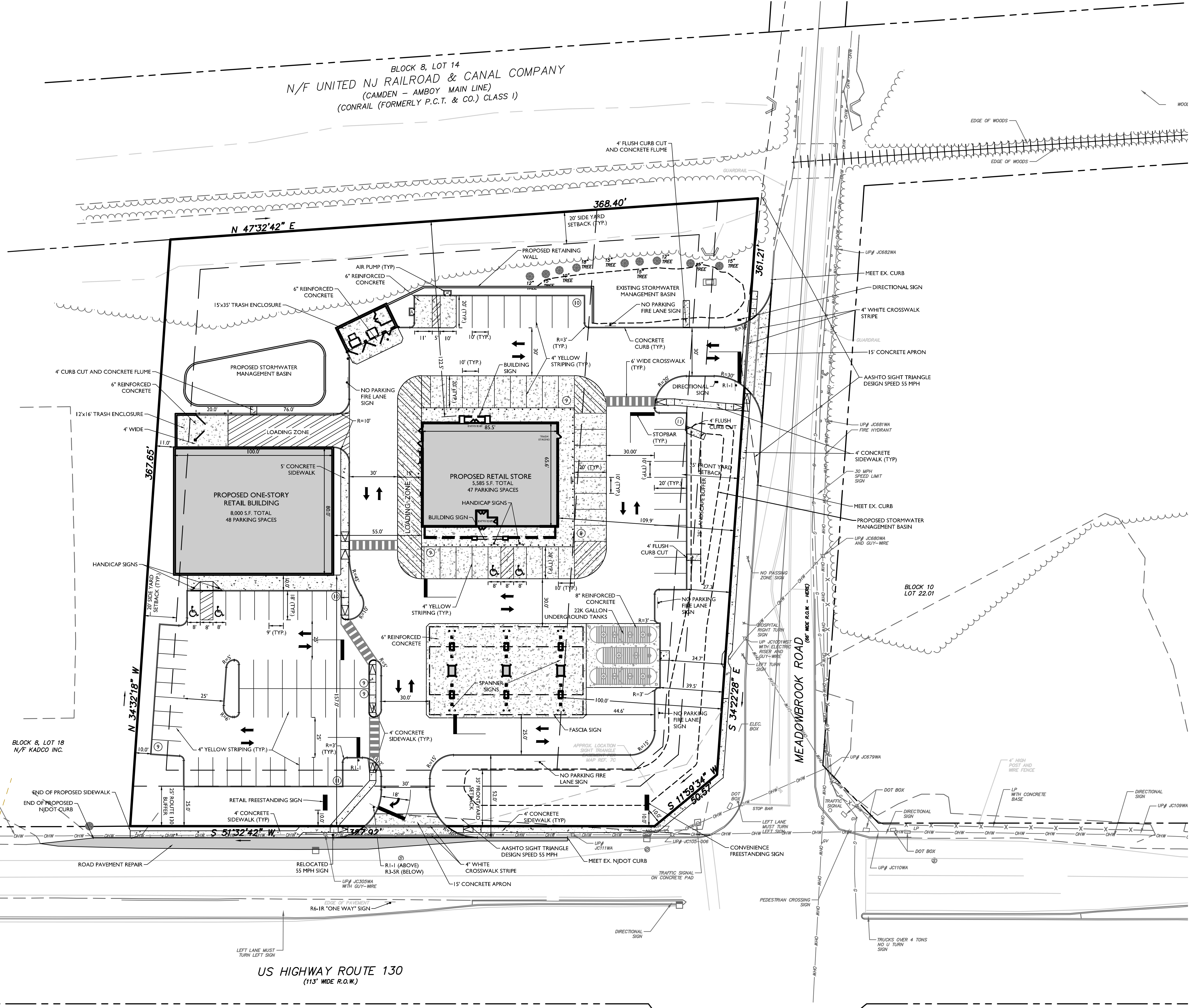

US HIGHWAY ROUTE 130
 (113' WIDE R.O.W.)

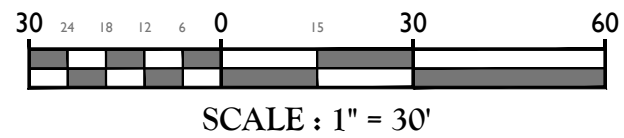

MASER CONSULTING, P.A.
 Customer Loyalty through Client Satisfaction
 www.maserconsulting.com
 Engineers • Planners • Surveyors
 Landscape Architects • Environmental Scientists

Office Locations:
 ■ Red Bank, NJ
 ■ Clinton, NJ
 ■ Hamilton, NJ
 ■ Egg Harbor, NJ
 ■ Flemington, NJ
 ■ Mt. Laurel, NJ
 ■ New Windsor, NY
 ■ Westchester, NY
 ■ Columbia, MD

■ Lehigh Valley, PA
 ■ Exton, PA
 ■ Philadelphia, PA
 ■ Pittsburgh, PA
 ■ Tampa, FL
 ■ Orlando, FL
 ■ Miami, FL
 ■ Albany, NY
 ■ Sterling, VA
 ■ Norfolk, VA
 ■ Albuquerque, NM
 ■ Charlotte, NC

State of NJ, Certificate of Authorization: 24GAZ7986500
 Copyright © 2017, Maser Consulting. All Rights Reserved. This drawing and all the information contained herein is authorized for use only by the party for whom the services were contracted or to whom it is certified. This drawing may not be copied, revised, disclosed, distributed or used in any other project without the express written consent of Maser Consulting, P.A.

811 PROTECT YOURSELF
 ALL STATES REQUIRE NOTIFICATION OF EDUCATORS, ENGINEERS OR ANY PERSON PREPARING TO DIG THE EARTH'S SURFACE ANYWHERE IN ANY STATE
 Know what's below. Call before you dig.
 FOR STATE SPECIFIC DIRECT PHONE NUMBERS VISIT: WWW.CALL811.COM

REV.	DATE	DRAWN BY	DESCRIPTION

MICHAEL F. GALLAGHER
 NEW JERSEY PROFESSIONAL ENGINEER - LICENSE NUMBER: GE48719

PRELIMINARY AND FINAL MAJOR SITE PLAN

FOR
ROBBINSVILLE MEADOWBROOK, LLC

BLOCK 8
 LOTS 15.01 & 17

TOWNSHIP OF ROBBINSVILLE
 MERCER COUNTY
 NEW JERSEY

RED BANK OFFICE
 Corporate Headquarters
 331 Newman Springs Road
 Suite 203
 Red Bank, NJ 07701
 Phone: 732.383.1950
 Fax: 732.383.1984

SCALE	DATE	DRAWN BY	CHECKED BY
AS SHOWN	12/06/17	PCS	MPG
PROJECT NUMBER:	1400185A	DRAWING NAME:	C-LAY1

SHEET TITLE
DIMENSION PLAN

SHEET NUMBER:
 3 of 20